



Vertical Diamond Cut Alloy Wheel Lathe: *TY30-VS*



The TY30-VS is ushering in a new era for diamond cut alloy wheels. This CNC vertical alloy wheel lathe is characterised by its innovative purpose built design. Built from the ground up both mechanically and electrically the system offers an easy to use touchscreen interface coupled with the latest state of the art real-time control software driving the latest in motion control digital drive technology. The CNC control is fitted with a 15.0" multi-touch screen and offers user-friendliness and precision coupled with reliability.

Other highlights such as a ultra-fast digitizer option , probing a typical 20" wheel in circa 3 minutes resulting in valuable savings in time for maximum wheel throughput. Additional features for storage of wheel profiles and CCD camera support for storing images of wheels are also included.

Mechanically a modern linear rail cross slide design is utilised, fitted to an inherently stable ribbed cast-iron frame.

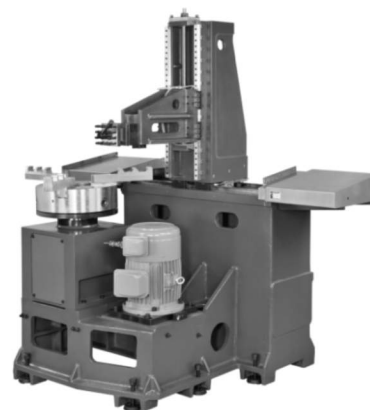
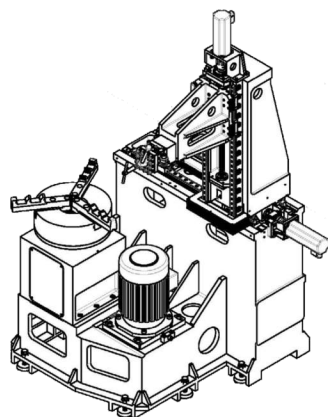

Being of compact design the footprint of the TY-30VS saves on valuable floor space but is capable of cutting wheels from 14" to **30"** in diameter.

Circular door design allows easy open accessibility to the working area, a steep sided work area floor guides the aluminum swarf to the catcher.

Simplified machine operation

A intuitive man machine touchscreen interface.

Simple **2 Stage** process, digitise wheel then cut wheel, no need to transfer data backwards and forwards to an offline PC as required by other manufactures offerings.

Stage 1 Digitise...

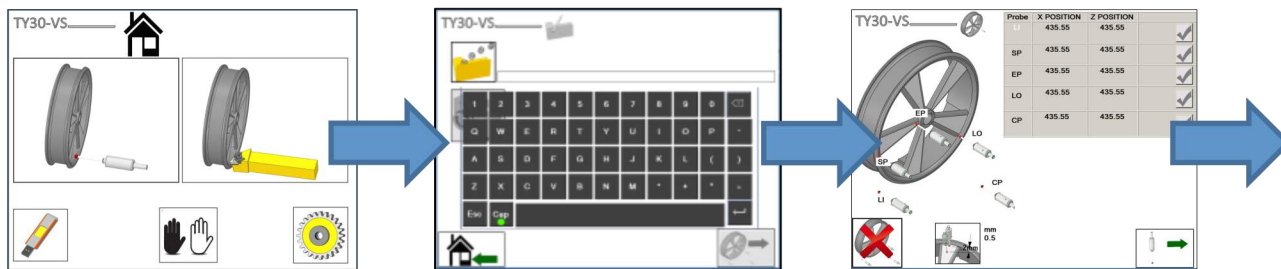

Press Digitise button

Enter name of wheel

Choose area to digitise

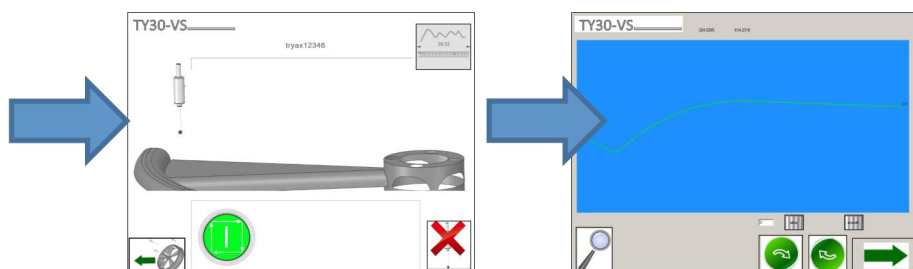

Press GO and digitise wheel

View digitised wheel profile

Stage 2 Cut Wheel....



Press Cut button

Select wheel to cut

Cut Wheel

Options

◆ Enhanced Digitising



The Enhanced ultra-fast digitizing option , probing a typical 20" wheel in circa 3 minutes resulting in valuable savings in time for maximum wheel throughput.



◆ Raid Data Pack

We include the Raid Data Pack which can store wheel profiles to two separate Solid State Discs. This provides additional security for your valuable wheel profile library.

◆ WheelCam



Take images of wheels and link with a wheel profile with this rugged machine mounted camera. Integrated seamlessly into the software with simple auto focus, just touch onscreen button when ready to capture image. Every time a wheel profile is loaded to be cut if an image of the wheel exists it is displayed on the screen allowing the operator to verify they are about to machine the correct wheel.

Floor plans

Plan view

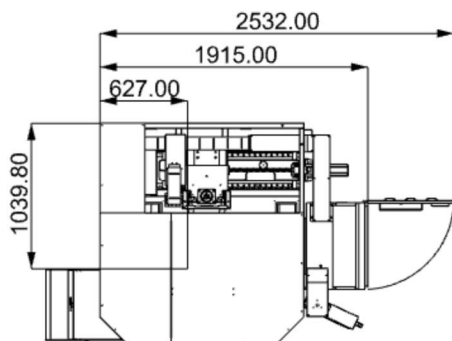

Front view

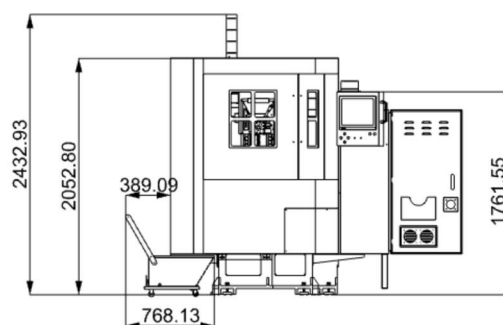

Side view

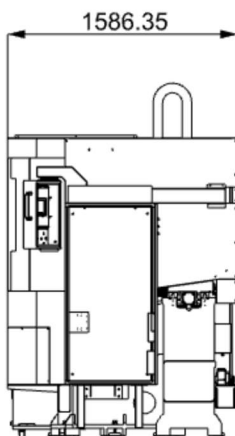

Perspective View

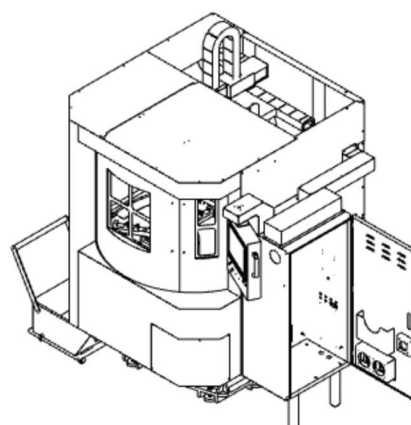

Technical data

Travel

X axis travel: 508 mm (20")
 Z axis travel: 457 mm (18")
 Max wheel diameter: 765 mm (30")

Table

Jaw chuck: 16" with 3 step soft jaw
 Alloy wheel Gripping O.D. range: 14"~30"

Spindle

Spindle motor (4P): 7.5kW(10HP)

Feed

X axis rapid traverse: 10 m/min
 Z axis rapid traverse: 10 m/min
 Cutting feedrate: 10 m/min

Installation requirements

Weight: 2300 kgs
 Machine dimension (L x W x H): 1600 mm x 1930 mm x 2641 mm

◆ Standard Accessories

◆ Diamond cutters	◆ Ethernet ports	◆ Digitizing probe
◆ USB ports	◆ Halogen work light	◆ Auto lube
◆ Four way tool post	◆ Chip cart	◆ Tools & tool box

◆ TY30-VS Options

Part Number	Description
100Y30ED-11	Enhanced Digitising
100Y30RD-14	Raid Data Pack
100Y30WC-15	WheelCAM

* MINT ALLOYS RESERVE THE RIGHT TO CHANGE DESIGN, COLOR, SPECIFICATIONS, OR PRICE WITHOUT NOTICE